

# DESIGN COMPETITION RULES

## Judging Criteria

**NOTE: Anyone judging Horticultural or Design classes at this show may NOT enter any Horticultural or Design class on either day.**

1. All Design and Horticultural exhibits will be judged by a designated team of judges selected by the Toronto Flower Show Convenors.
2. Judges at this year's show will not be permitted on the show floor during entry times for exhibits.
3. No one other than those authorized by the Show Committee will be permitted into the area of the Toronto Flower Show where judging is in progress and no one may discuss the exhibits with the judges prior to judging.
4. Designs must not be altered in any manner after judging. Deteriorating plant material however, must be replaced in order to keep the exhibit in show condition.
5. The decision of the Judges is final.

**The following rules apply to all Design Competitions. Note that only non-professionals may compete.**

1. General Regulations (pages 6- 8) Judging Criteria (above) and the *Ontario Judging and Exhibiting Standards for Horticulture and Floral Design* (2003 edition) apply.  
In addition, International Flower Show Rules, World Association of Floral Artists (WAFA) will apply:
  - a) An exhibit is made of plant material, with or without accessories, within a space specified in the Show Schedule.
  - b) Plant material must predominate over all other components of the exhibit.
  - c) The use of artificial plant material is forbidden unless stated in the regulations.
  - d) Fresh plant material must be in water or in water-retaining material unless such material remains turgid throughout the event.
  - e) Painted and/or artificially coloured plant material may be used unless otherwise stated in the regulations.

For this show only, portions of any Design or Special Exhibit entry requiring work not able to be completed in the time allotted may be done in advance.

In the event of any conflict, the above rules will prevail.

2. Exhibitors are requested to notify convenors as soon as possible, which dates and classes they wish to enter. Do not wait to be called. Space will be reserved for each exhibit when notice is received and confirmed by email, telephone or letter. **Exhibitors unable to fulfill their responsibility must find their own substitute.**
3. Exhibitors may submit only 1 exhibit in each class.
4. All classes are limited to 5 exhibits each entry day except where noted in the Schedule.
5. First day exhibits will be received between 8:00 p.m. and 11:00 p.m. on Wednesday March 7, and between 7:00 a.m. and 12:30 p.m. on Thursday, March 8, 2018. First day exhibits must be removed at 6:00 p.m. on Tuesday, March 13, 2018.
6. Second day exhibits will be received between 6:30 p.m., Tuesday, March 13 and 1:00 a.m., Wednesday March 14 and between 7:00 a.m. and 9:00 a.m. on Wednesday, March 14, 2018.
7. All designs must be in place and ready for the Passing Committee at the following times:  
**Thursday, March 8, by 12:30 p.m. for judging at 1:00 p.m. They must remain in place until removal on Tuesday, March 13 at 7:30 p.m.**  
**Wednesday, March 14 by 9:00 a.m. for judging at 9:30 a.m.**  
**There will be a warning bell 15 minutes prior to the time of clearing the judging area on both entry days.**
8. All Exhibits must be kept in show condition. Deteriorating plant material must be replaced.
9. If a design has a mechanical failure after the entry time is closed, it may not be repaired until judging is completed. After judging it must be repaired to its original status for the duration of the show.
10. No exhibit may be altered in any manner after it has been judged, except to restore it to its original condition according to rule #8 or #9.
11. Maintenance may be done at any time during the show, including public open hours. Please ensure that you are wearing appropriate ID.
12. The Toronto Flower Show Chair and/or the Floral Design Chair may remove an exhibit if deemed necessary.
13. All exhibits must be removed promptly on Sunday, March 18 at **5:00 p.m.**
14. **All designs must be made and staged by the exhibitors themselves. Any competitor receiving help with put-in other than help that is physically necessary will be disqualified.**

15. All exhibitors are asked to leave their completed entry sheet with their design at the time of entry. It should include: name, class, date, a list of plant material in the design, including both common and botanical names and explanation of containers of interest. See *Snippy Tips #1*. **Novice designation must be included on the entry sheet.** The list of material in the design should be duplicated, in block capitals or typed to be available for the judges.
16. Check with your class convenor to see that your design meets all requirements set out in the schedule. **A design which does not comply will not be judged.** This will be at the sole discretion of the Design Committee Chair. **You may not leave the design area until your design is accepted by the Passing Committee.** This will be indicated by the letter **P** marked on your entry card.
17. While every effort has been made to ensure accuracy, note that measurements may vary slightly.

Regarding liability - see General Regulations page 7.

#### Points Awarded

First	6 points
Second	4 points
Third	2 points
Honourable Mention	1 point

#### Scale of Judging Points (except where otherwise stated)

Design: Organization of the elements and principles.	35 points
Conformance: Compliance with scheduled requirements, theme.	25 points
Creativity: Originality of concept in choice of components, and/or organization of design elements according to the principles of design.	20 points
Distinction and Condition: Marked superiority and physical state of plant material at time of judging	20 points

Scale of Points for Tables: see *Ontario Judging Standards* (2003 edition)

Scale of Points for Miniatures: see *Ontario Judging Standards* (2003 edition)

**Deductions will be proportionate to the degree of non-compliance.**

NOTE: throughout the schedule, \* denotes Benjamin Moore Paint Colour

# DESIGN COMPETITION SCHEDULE DAY 1

## Friday, March 9, 2018

Set up: Day 1 exhibits will be received between 8:00 p.m. and 11:00 p.m. on Wednesday March 7, and between 7:00 a.m. and 12:30 p.m. on Thursday, March 8, 2018.

Removal: First day exhibits must be removed at 6:00 p.m. on Tuesday, March 13, 2018.

---

**NOVICE CLASS** Open to members of The Garden Club of Toronto who have not previously won a red ribbon in any major Garden Club of Toronto show or Canada Blooms show (excluding monthly Neil Cup and Margaret Dove competitions).

### Class 101 FAIRY TALE

A hand tied bouquet, tied with ribbon and placed in a glass vase, suitable for a wedding

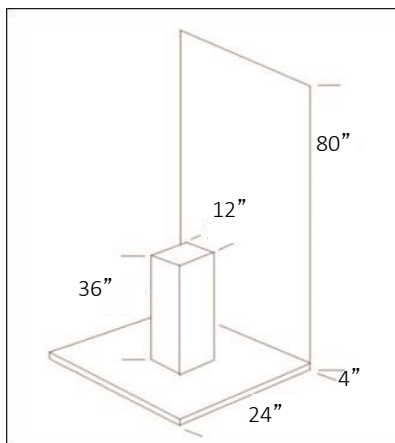

**Staged:** on a pedestal 12" wide x 12" deep (30.5 cm x 30.5 cm) standing 36" high (91 cm), on a square base 24" x 24" (61 cm x 61 cm) and 4" high (10 cm) staged against a background 48" wide x 80" high (61 cm x 203 cm)

Limited to 5 entries

**Area Allotted:** 30" wide x 30" deep (76 cm x 76 cm) No height restriction

**Pedestal Colour and Base Colour:** Simply White OC-117\*

**Background Colour:** Tear Drop Blue 2053-60\*

### Convenors:

Dianne Gillin 416-929-7176 [dianne.sloangillin@gmail.com](mailto:dianne.sloangillin@gmail.com)

Frederika Winchell-Jubb 416-483-0776 [f.winchelljubb@gmail.com](mailto:f.winchelljubb@gmail.com)

---

## Class 102 DRAMA

A modern mass design

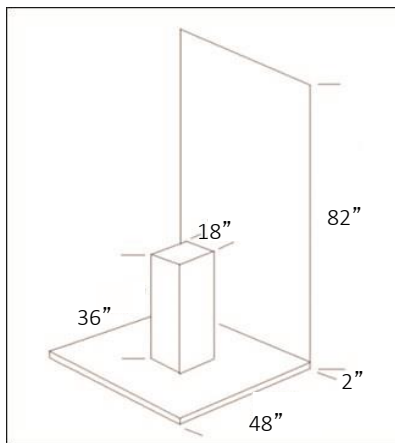

**Staged:** on a pedestal 18" wide x 18" deep x 36" high (46 cm x 46 cm x 91.5 cm) on a base 48" wide x 48" deep x 2" high (122 cm x 122 cm x 5 cm) against a background panel 48" wide x 82" high (122 cm x 208 cm)

**Area Allotted:** 48" wide x 48" deep x 82" high (122 cm x 122 cm x 208 cm)

Limited to 5 entries

**Pedestal Colour:** Tear Drop Blue 2053-60\*

**Base and Background Colour:** Brilliant Blue 2065-30\*

### Convenors:

Katherine Shaw 416-480-9595 vkatherineshaw@gmail.com

Mona Horvath 416-446-0409 horvathm@sympatico.ca

---

## Class 103 AVANT GARDE

An abstract design

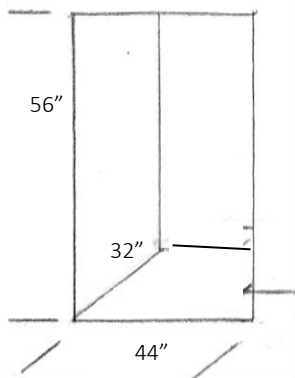

**Staged:** in a niche. Design may be hung. Nothing to be attached to the walls.

**Area Allotted:** 44" wide x 32" deep x 56" high (111.5 cm x 81 cm x 142 cm)

Limited to 5 entries

**Niche Colour:** Tomato Red 2010-10\*

**Set Colour:** Blue Lake 2053-40\*

### Convenors:

Ellen Clark 416-486-9352 ellen.clark@sympatico.ca

Trudy Grantham 416-691-5333 tgrantham@sympatico.ca

---

## Class 104 SCI FI

A miniature design using predominately dried plant material  
Design must not exceed 5" (12.5 cm) in any direction.

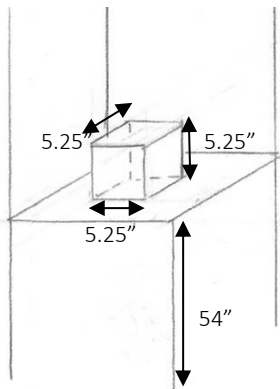

**Staged:** in a clear acrylic cube 5.25" wide x 5.25" deep x 5.25" high (13 cm x 13 cm x 13 cm) set on a pedestal 54" high (137 cm) against a background. Design may be hung. Entrants may supply their own mat on the back of acrylic cube.

Limited to 5 entries

**Pedestal and Background colour:** Tear Drop Blue 2053-60\*

### Convenors:

Lynda Summerville 416-690-5434 dean.lynda@rogers.com

Loris Adamson 416-519-9397 lorisadamson@me.com

---

## Class 105 FANTASY

A miniature design using predominately fresh plant material  
Design must not exceed 5" (12.5 cm) in any direction.

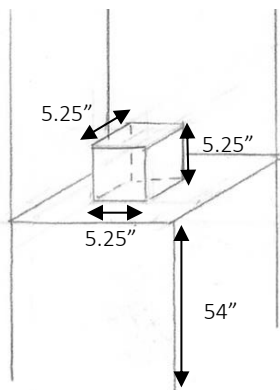

**Staged:** in a clear acrylic cube 5.25" wide x 5.25" deep x 5.25" high (13 cm x 13 cm x 13 cm) set on a pedestal 54" high (137 cm) against a background. Design may be hung. Entrants may supply their own mat on the back of acrylic cube.

Limited to 5 entries

**Pedestal and Background colour:** Tear Drop Blue 2053-60\*

### Convenors:

Linda Alcock 416-481-9894 linal22@yahoo.com

Tara Bramall 416-489-5383 tara8@rogers.com

---

## Class 106 FILM NOIR

A design to be viewed from all sides but judged from the front

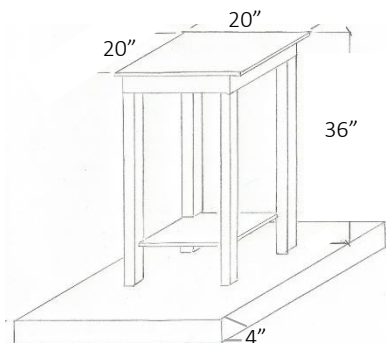

**Staged on:** an open-sided pedestal 20" wide X 20" deep and 36" high (50 cm x 50 cm x 90 cm) on a base 36" wide x 36" deep x 4" high (91 cm x 91 cm x 10 cm)

**Area Allotted:** 36" wide x 36" deep (91 cm x 91 cm) Height unlimited

Limited to 5 entries

**Pedestal and Base Colour:** Blue Lake 2053-40\*

### Convenors:

Joyce Moffat 416-445-0813 joycemoffat@rogers.com

Claudia Pedone 416-447-9122 claudia.j.pedone@gmail.com

---

## Class 107 SUSPENSE

A suspended design

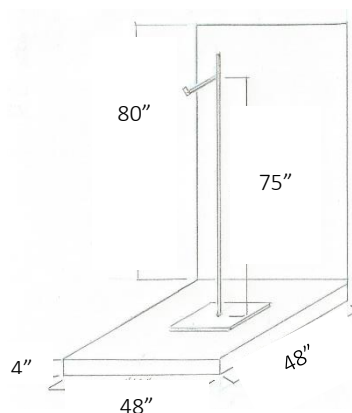

Design must be equipped to hang and must not exceed 10 lbs. (4.5 kg.) in weight

**Staged:** To be hung from a black free standing wrought iron stand on a base 48" wide x 48" deep x 4" high (122 cm x 122 cm x 10 cm) against a background panel 48" wide x 80" high (122 cm x 203 cm). Hook for hanging will be approximately 75" (190 cm) above the base.

**Base and Background Colour:** Blue Lake 2053-40\*

Limited to 5 entries

### Convenors:

Judith James 416-960-2010 judithejames@rogers.com

Celia Roberts c.905-510-6534 celiaroberts62@bell.net

---

## Class 108 CHICK FLICK

A functional table design

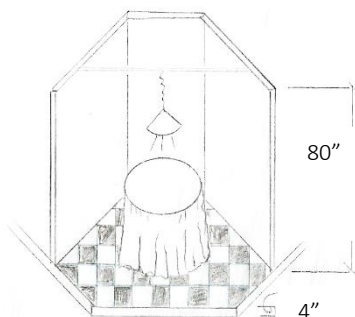

**Staged:** on a table 39" in diameter (99 cm) and 29" high (74 cm) against a background 36" wide x 80" high (91 cm x 203 cm)

Accessories may be attached to the background. Shabby chic chandelier hangs 27" (69 cm) above the table. Black and white tile floor.

Limited to four entries

**Background Wall:** Passion Blue 2053-50\*

### Convenors:

Donna Buss 416-445-2843 gbuss@rogers.com

Carolyn Whiteside 416-231-1771 cwhiteside35@rogers.com

---

## Class 109 DISNEY CLASSICS

A design for a dress inspired by a Disney character staged on a life-size female form mannequin. The design is to be created with plant material and may include a judicious use of plant-derived materials. To be viewed from all sides.

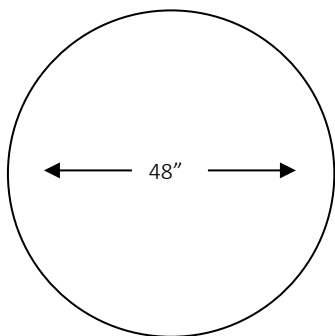

**Staged:** on a circular base with 48" diameter and 4" high (122 cm x 10 cm) on red carpet

**Base Colour:** Simply White OC-117\*

Mannequin will be provided to exhibitor in advance. Exhibitor should choose the female Disney character she wishes to portray and sign up with the convenor. No duplication of names – first come, first served. Indicate the name of your Disney character on your entry form.

**Area Allotted:** Circular area with 48" (122 cm) diameter. No height restriction.

First day entry only. Limited to 5 entries. This exhibit will remain in the show for 10 days.

### Convenors:

Tree lerullo 416-929-6962 treehouse1.99@gmail.com

Deborah Landers 416-485-3557 landers@rogers.com



---

## Class 110 BEACH PARTY

A design depicting swimwear staged on a life-size female form mannequin. The design is to be created with plant material and may include a judicious use of plant-derived material. To be viewed from all sides.

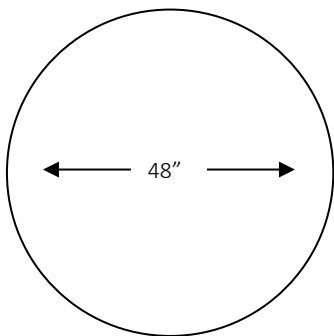

**Staged:** on a circular base with 48" diameter and 4" high (122 cm x 10 cm) set on a sand covered floor

**Base Colour:** Tear Drop Blue 2053-60\*

Mannequin will be provided to exhibitor in advance.

**Area Allotted:** Circular area with 36" (91 cm) diameter. No height restriction.

First day entry only.

Limited to 5 entries. This exhibit will remain in the show for 10 days.

### Convenors:

Deborah Landers 416-485-3557 landers@rogers.com

Tree lerullo 416-929-6962 treehouse1.99@gmail.com

---

## Class 111 WESTERN

A landscape design to be viewed from above. Accessories permitted.

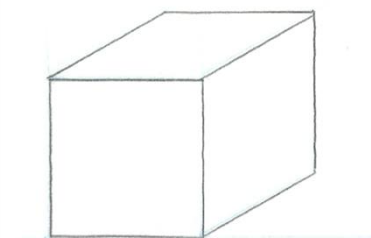

24" x 24" x 24"

**Staged:** on a cube 24" wide x 24" deep x 24" high (60 cm x 60 cm x 60 cm)

**Area Allotted:** 30" wide x 30" deep (76 cm x 76 cm) Height unlimited

Limited to 4 entries

**Colour of Cube:** Passion Blue 2053-50\*

### Convenors:

Jacqui Miller 416-274-2891 millerjacqui@hotmail.com

Marg Betts 416-699-3597 margbetts@rogers.com

---

## Class 112 ROMANCE

An Ikebana design

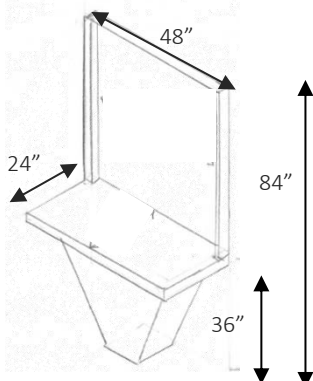

**Staged** on shelf 48" wide x 24" deep (122 cm x 61 cm) 36" (91.5 cm) above the floor

**Area Allotted:** 44" wide x 30" deep x 84" high (112 cm x 76 cm x 213 cm)

**Background and Shelf Colour:** Simply White OC-117\*

**Frame Colour:** Simply White OC-117\*

Limited to 5 entries

### Convenors:

Sue Clarkson 416-763-3918 sueclarkson@gmail.com

Nora Cowie 416-486-0756 noracowie@rogers.com

---

**OPEN CLASS:** Open to members of garden clubs and horticultural societies other than The Garden Club of Toronto.

## Class 113 IMPROV

An imposed class

Material will be provided and a fee of \$90 will be charged. Exhibitor will have 3 hours to create their design: from 9:30 a.m. until 12:30 p.m. on Thursday, March 8, 2018. Exhibitor may use whatever provided material they wish in creating their design and need not use all the material.

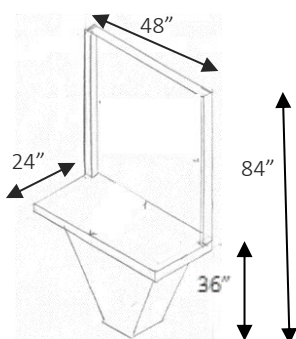

**Staged** on shelf 48" wide x 24" deep (122 cm x 61 cm) 36" (91.5 cm) above the floor

**Area Allotted:** 44" wide x 30" deep x 84" high (112 cm x 76 cm x 213 cm)

**Background and Shelf Colour:** Brilliant Blue 2065-30\*

**Frame Colour:** Simply White OC-117\*

Limited to 5 entries

### Convenors:

Ursula Eley 416-699-4353 eley@rogers.com

Heather Gray 416-445-2910 hgrayis@rogers.com

---

## **Class 114 THRILLER**

**OPEN CLASS:** Open to all members of garden clubs and horticultural societies including The Garden Club of Toronto.

An assemblage

A three- dimensional abstract design combining previously unrelated dried or preserved plant material and found objects into an integrated whole.

**Note:** This exhibit will remain in the show for 10 days. Entries must be registered and received by February 8, 2018 or registered with the convenor in advance and entered in person on the first entry day. All entries must be removed on March 18, 2018 at 5:00 p.m.

**Staged:** to be attached to a backdrop square board 28" x 28" (71 cm x 71 cm) already affixed to the wall. The exhibitor must equip the assemblage with a picture wire for hanging on the board.

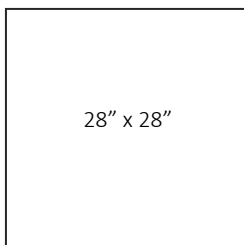

**Area Allotted:** Material may extend over your own mat but must not exceed the dimensions of the 28" x 28" (71 cm X 71 cm) square; however, the exhibitor may choose the size and shape of their design. Design may be framed or unframed and any shape. Plant material may be in its natural state and any or all may be dyed or painted. Maximum depth 6" (15 cm) from the back of your design.

First Day entry only. Limited to 18 entries.

**Background Colour:** Tomato Red 2010-10\*

**Display Board Colour:** Simply White OC-117\*

### **Convenors:**

Marilyn Walsh 416-461-8714 marilyn\_walsh@rogers.com

Marsha Pine 416-461-4466 mpine@rogers.com

---

## INTERNATIONAL CLASS

### Class 115 EXPERIMENTAL

A design

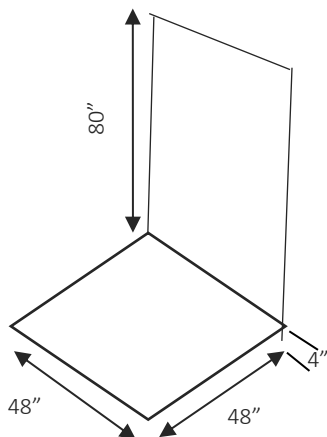

**Staged:** on a base 48" wide x 48" deep x 4" high (122 cm x 122 cm x 10 cm) against a background panel 48" wide x 80" high (122 cm x 203 cm)

**Area Allotted:** 48" wide x 48" deep x 80" high (122 cm x 122 cm x 203 cm)

Day 1 entry only. Limited to 10 exhibitors

Base and Background Colour: Blue Lake 2053-40\*

Entries: Invitational Class

#### Convenors:

Sue Schaal 416-922-7875 [schaal@sympatico.ca](mailto:schaal@sympatico.ca)

Margaret Taylor 416-440-0490 [margaret.taylor@gmail.com](mailto:margaret.taylor@gmail.com)

# DESIGN COMPETITION SCHEDULE DAY 2

## Tuesday, March 14, 2018

Set up: Day 2 exhibits will be received between 8:00 p.m., Tuesday, March 13 and 1:00 a.m., Wednesday March 14 and between 7:00 a.m. and 9:00 a.m. on Wednesday, March 14, 2018.

Removal: Must be removed promptly on Sunday, March 18 at 5:00 p.m.

---

### NOVICE CLASS

Open to members of The Garden Club of Toronto who have not previously won a red ribbon in any major Garden Club of Toronto show or Canada Blooms show (excluding monthly Neil Cup and Margaret Dove competitions)

### Class 201 FAIRY TALE

A hand tied bouquet, tied with ribbon and placed in a glass vase, suitable for a wedding

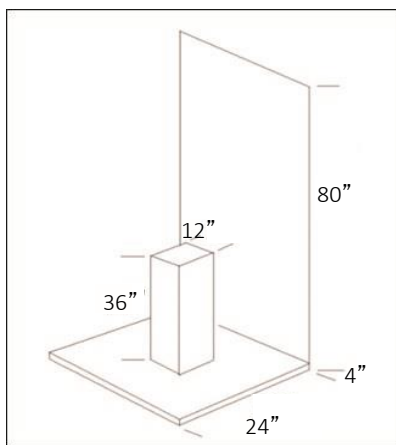

**Staged:** on a pedestal 12" wide x 12" deep (30.5 cm x 30.5 cm) standing 36" high (91 cm), on a square base 24" x 24" (61 cm x 61 cm) and 4" high (10 cm) staged against a background 48" wide x 80" high (61 cm x 203 cm)

Limited to 5 entries

**Area Allotted:** 30" wide x 30" deep (76 cm x 76 cm) No height restriction

**Pedestal Colour and Base Colour:** Simply White OC-117\*

**Background Colour:** Tear Drop Blue 2053-60\*

### Convenors:

Dianne Gillin 416-929-7176 [dianne.sloangillin@gmail.com](mailto:dianne.sloangillin@gmail.com)

Frederika Winchell-Jubb 416-483-0776 [f.winchelljubb@gmail.com](mailto:f.winchelljubb@gmail.com)

---

## Class 202 DRAMA

A modern mass design

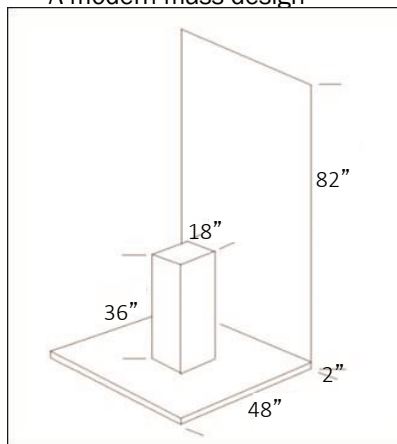

**Staged:** on a pedestal 18" wide x 18" deep x 36" high (46 cm x 46 cm x 91.5 cm high) on a base 48" wide x 48" deep x 2" high (122 cm x 122 cm x 5 cm) against a background panel 48" wide x 82" high (122 cm x 208 cm)

**Area Allotted:** 48" wide x 48" deep x 82" high (122 cm x 122 cm x 208 cm)

Limited to 5 entries

**Pedestal Colour:** Tear Drop Blue 2053-60\*

**Base and Background Colour:** Brilliant Blue 2065-30\*

### Convenors:

Katherine Shaw 416-480-9595 vkatherineshaw@mail.com

Mona Horvath 416-446-0409 horvathm@sympatico.ca

---

## Class 203 AVANT GARDE

An abstract design

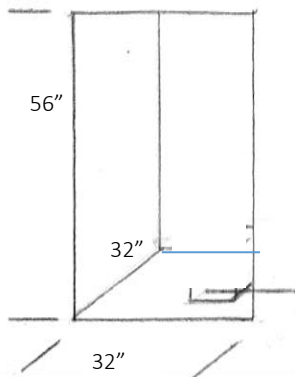

**Staged:** in a niche. Design may be hung. Nothing to be attached to the walls.

**Area Allotted:** 44" wide x 32" deep x 56" high (111.5 cm x 81 cm x 142 cm)

Limited to 5 entries

**Niche Colour:** Tomato Red 2010-10\*

**Set Colour:** Blue Lake 2053-40\*

### Convenors:

Ellen Clark 416-486-9352 ellen.clark@sympatico.ca

Trudy Grantham 416-691-5333 tgrantham@sympatico.ca

---

## Class 204 SCI FI

A miniature design using predominately dried plant material.  
Design must not exceed 5" (12.5 cm) in any direction.

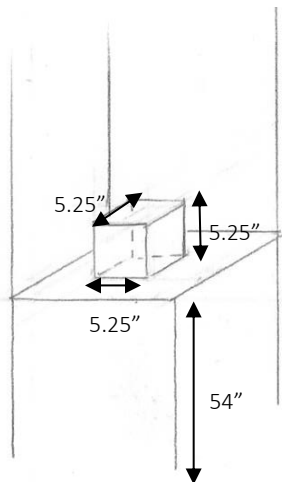

**Staged:** in a clear acrylic cube 5.25" wide x 5.25" deep x 5.25" high (13 cm x 13 cm x 13 cm) set on a pedestal 54" high (137 cm) against background. Design may be hung. Entrants may supply their own mat on the back of the acrylic cube.

Limited to 5 entries

**Background colour:** Tear Drop Blue 2053-60\*

### Convenors:

Lynda Summerville 416-690-5434 dean.lynda@rogers.com

Loris Adamson 416-519-9397 lorisadamson@me.com

---

## Class 205 FANTASY

A miniature design using predominately fresh plant material  
Design must not exceed 5" (12.5 cm) in any direction.

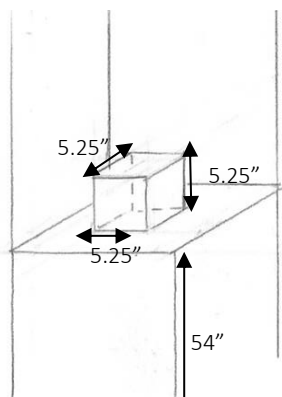

**Staged:** in a clear acrylic cube 5.25" wide x 5.25" deep x 5.25" high (13 cm x 13 cm x 13 cm) set on a pedestal 54" high (137 cm) against a background. Design may be hung. Entrants may supply their own mat on the back of the acrylic cube.

Limited to 5 entries

**Pedestal Background colour:** Tear Drop Blue 2053-60\*

### Convenors:

Linda Alcock 416-481-9894 linal22@yahoo.com

Tara Bramall 416-489-5383 tara8@rogers.com

---

## Class 206 FILM NOIR

A design to be viewed from all sides but judged from the front

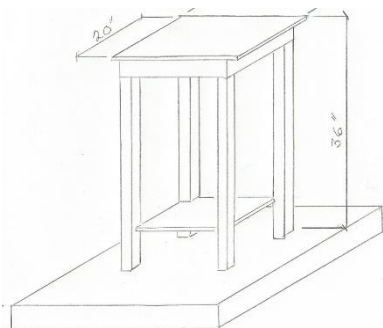

**Staged on:** an open sided pedestal 20" wide X 20" deep and 36" high (50 cm x 50 cm x 90 cm) on a base 36" wide" x 36" deep (91 cm x 91 cm)

**Area Allotted:** 36" wide x 36" deep (91 cm x 91 cm) Height unlimited

Limited to 5 entries

**Pedestal and Base Colour:** Blue Lake 2053-40\*

### Convenors:

Joyce Moffat 416-445-0813 joycemoffat@rogers.com

Claudia Pedone 416-447-9122 claudia.j.pedone@gmail.com

---

## Class 207 SUSPENSE

A suspended design

Design must be equipped to hang and must not exceed 10 lbs. (4.5 kg.) in weight

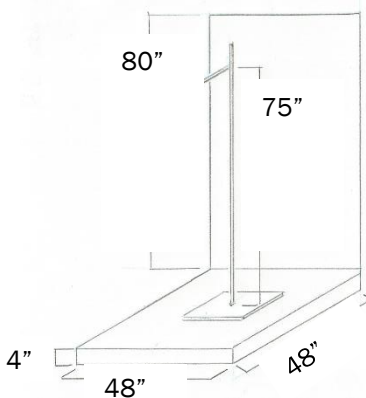

**Staged:** To be hung from a black free standing wrought iron stand on a base 48" wide x 48" deep x 4" high (122 cm x 122 cm x 10 cm) against a background panel 48" wide x 80" high (122 cm x 203 cm). Hook for hanging will be approximately 75" (190 cm) above the base.

**Base and Background Colour:** Blue Lake 2053-40\*

Limited to 5 entries

### Convenors:

Judith James 416-960-2010 judithejames@rogers.com

Celia Roberts c.905-510-6534 celiaroberts62@bell.net



---

## Class 208 CHICK FLICK

A functional table design

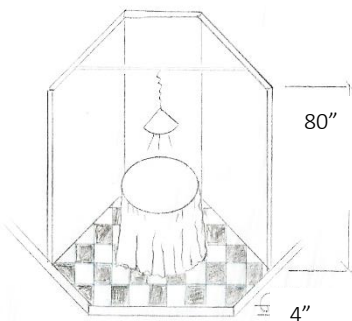

**Staged:** on a table 39" (99 cm) in diameter and 29" high (74 cm) against a background 36" wide x 80" high (91 cm x 203 cm)

Accessories may be attached to the background. Shabby chic chandelier hangs 27" (69 cm) above the table. Black and white tile floor.

Limited to four entries

**Background Wall:** Passion Blue 2053-50\*

### Convenors:

Donna Buss 416-445-2843 gbuss@rogers.com

Carolyn Whiteside 416-231-1771 cwhiteside35@rogers.com

---

## Class 209 ACTION

A large design

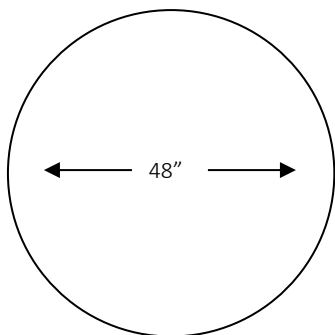

**Staged:** on a base 48" wide x 48" deep x 4" high (122 cm x 122 cm x 10 cm) against a background panel 48" wide x 80" high (122 cm x 203 cm)

**Area Allotted:** 48" wide x 48" deep x 80" high (122 cm x 122 cm x 203 cm)

Second day entry only. Limited to 5 entries.

**Base and Background Colour:** Blue Lake 2053-40\*

### Convenors:

Rosemary Passafiume-Mclean 416-284-6959

rosemary.passafiume.mclean@gmail.com

Sandra Williamson lately@hotmail.com

---

## Class 210 EPIC

A large design

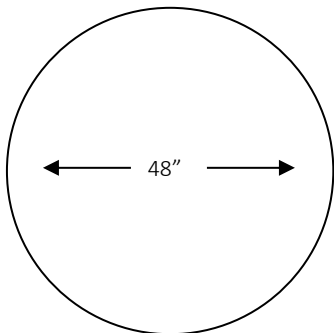

**Staged:** on a base 48" wide x 48" deep x 4" high (122 cm x 122 cm x 10 cm) against a background panel 48" wide x 80" high (122 cm x 203 cm)

**Area Allotted:** 48" wide x 48" deep x 80" high (122 cm x 122 cm x 203 cm)

Second day entry only. Limited to 5 entries.

**Base and Background Colour:** Blue Lake 2053-40\*

### Convenors:

Rosemary Passafiume-Mclean 416-284-6959

rosemary.passafiume.mclean@gmail.com

Lillian Taggart 289-891-9668 liltovey@hotmail.com

---

## Class 211 WESTERN

A landscape design to be viewed from above. Accessories permitted.

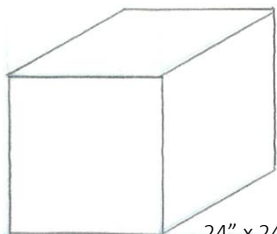

**Staged:** on a cube 24" wide x 24" deep x 24" high (60 cm x 60 cm x 60 cm)

**Space Allotted:** 30" wide x 30" deep (76 cm x 76 cm)

Limited to 4 entries each entry day

**Colour of Cube:** Passion Blue 2053-50\*

### Convenors:

Marg Betts 416-699-3597 margbetts@rogers.com

Jacqui Miller 416-274-2891 millerjacqui@hotmail.com

---

## Class 212 ROMANCE

An Ikebana design

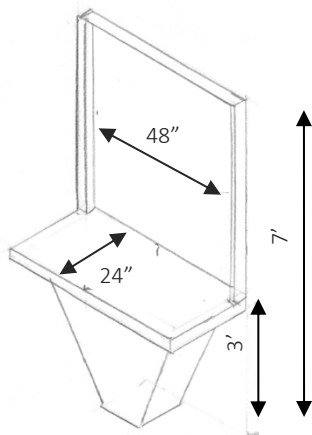

**Staged** on shelf 48" wide x 24" deep (122 cm x 61 cm) 36" (91.5 cm) above the floor

**Area Allotted:** 44" wide x 30" deep x 84" high (112 cm x 76 cm x 213 cm)

**Background and Shelf Colour:** Simply White OC-117\*

**Frame Colour:** Simply White OC-117\*

**Convenors:**

Sue Clarkson 416-763-3918  
sueclarkson@gmail.com

Nora Cowie 416-486-0756  
noracowie@rogers.com

---

**OPEN CLASS:** Open to members of garden clubs and horticultural societies other than The Garden Club of Toronto.

## Class 213 IMPROV

An Imposed class.

Material will be provided and a fee of \$90 will be charged. Exhibitor will have 3 hours to create their design: from 6:30 P.M. until 9:30 P.M. on Tuesday, March 13, 2018. Exhibitor may use whatever provided material they wish in creating their design and need not use all the material.

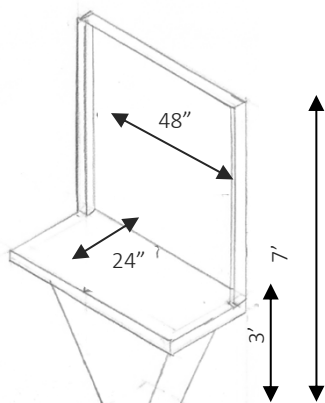

**Staged** on shelf 48" wide x 24" deep (122 cm x 61 cm) 36" (91.5 cm) above the floor

**Area Allotted:** 44" wide x 30" deep x 84" high (112 cm x 76 cm x 213 cm)

**Background and Shelf Colour:** Brilliant Blue 2065-30\*

**Frame Colour:** Simply White OC-117\*

Limited to 5 entries

**Convenors:**

Ursula Eley 416-699-4353 eley@rogers.com  
Heather Gray 416-445-2910 hgrayis@rogers.com