

CANADA BLOOMS

‘THE MAGIC OF SPRING’

THE TORONTO

FLOWER & GARDEN FESTIVAL

MARCH 15 – 24, 2013

DIRECT ENERGY CENTRE, EXHIBITION PLACE



Founded By:



Landscape Ontario
HORTICULTURAL TRADES ASSOCIATION

&



the Garden Club of Toronto

COMPETITOR'S SCHEDULE

Canada Blooms 2013

The Toronto Flower and Garden Festival

March 15 – 24

Direct Energy Centre
Exhibition Place
Toronto, Ontario M6K 3C3

Show Hours

Friday, March 15	10 a.m. – 9 p.m.
Saturday, March 16	10 a.m. – 9 p.m.
Sunday, March 17	10 a.m. – 6 p.m.
Monday, March 18	10 a.m. – 9 p.m.
Tuesday, March 19	10 a.m. – 9 p.m.
Wednesday, March 20	10 a.m. – 9 p.m.
Thursday, March 21	10 a.m. – 9 p.m.
Friday, March 22	10 a.m. – 9 p.m.
Saturday, March 23	10 a.m. – 9 p.m.
Sunday, March 24	10 a.m. – 5 p.m.

Tickets

Adult	\$20.00 (\$18 advance purchase on line at www.canadablooms.com)
Seniors	\$18.00 (\$16 in advance)
Children 12 and under	FREE
Evening tickets, purchased between 6:00 p.m. – 9:00 p.m.	\$14.00
Bus groups of 20 or more - reservations only*	\$14.00 (includes show program)
Early Morning Tours	\$40.00 (includes 8:15 a.m. tour, and Full day admission) –reservation only*

*Must contact Canada Blooms Office in advance

New this year: Evening Tours: Check Canada Blooms website for details

To order tickets, please complete the **Ticket Order Form** loosely inserted in the middle of this booklet

Parking Monday to Thursday after 4 p.m. is FREE

For show information contact:

Canada Blooms

777 Lawrence Avenue East, Toronto, Ontario, M3C 1P2
Tel: 416-447-8655: 1-800-730-1020 (Toll-free in Ontario)
Email: info@canadablooms.com Web: www.canadablooms.com



‘The Magic of Spring’

Welcome back to the Direct Energy Centre! With Canada Blooms co-location with the National Home Show, we are now the largest combined home and garden event in Canada.

Canada Blooms theme this year is the “The Magic of Spring” featuring the beautiful spring flower, the Hellebore. This schedule’s class titles, such as Sorcery, Wizard, Bursting, Enchanting, Bewitching, Bedazzling, Devilish, Spellbinding, to name a few, will titillate your creative juices in both Horticulture Special Exhibits and Floral Design.

All Toronto Flower Show entrants are invited to the Awards Ceremony on the Canada Blooms main stage, Sunday, March 24, 2013 at 3:00 p.m. This year all youth exhibitors will receive their ribbons at the Awards Ceremony.

The Canada Blooms Horticultural Society was founded by Landscape Ontario and the Garden Club of Toronto in 1997. Both organizations are deeply committed to Canada Blooms in bringing knowledge and love of gardening, horticulture and design to the public. Your participation in the non-professional floral design and horticulture competitions adds to the ongoing success of Canada Blooms with every entry. Photography, Youth and a number of horticulture and design classes are “Open” meaning anyone is welcome to participate.

This magical schedule will entice you to send in your entry form today!

Arvils Lukss
Landscape Ontario
Co-Chair Canada Blooms
2012 - 2013

Mary Lou Tigert
Garden Club of Toronto
Co-Chair Canada Blooms
2012 – 2013

“The Magic of Spring”

The Toronto Flower Show

Chair

Anne Watkinson

Schedule Design

Roz Titley
Ursula Eley

The Toronto Flower Show Design and Layout

Karen Morgan
Joyce Johnson

Show Designer

Colomba Fuller

Awards

Dianne Gillin

Volunteer Coordination

Ann Moffatt
Barbara Smith
Dora Nast

Publicity and Communications

Liz Crookston

Horticultural Section

Co-Chairs

Ursula Eley
Dyann Sheppard

Schedule Writers

Diana Kennedy
Janet Marsh Frosst

Open Classes

Convenor
Silvana Croce

Registration

Convenor
Connie Hunter

Staging

Gunnel Brandkvist
Mona Horvath

Convenor of

Convenors
Sue Schaal

Clerks Convenor

Janet Kennish
Libbi Scully

Judges Convenor

Linda Alcock

Statistician

Julia Nairne

Design Section

Chair

Joyce Moffatt

Schedule Writers

Sue Schaal
Lynda Summerville

International Class

Margaret Taylor
Tree Ierullo
Jackie David
Rosemary Passafiume
-McLean

Clerks Convenor

Mandy Macrae

Judges Convenor

Celia Roberts

Entries Convenor

Sue Schaal

Convenor of

Convenors

Lee Till

Staging

Karen Morgan
Joyce Johnson

Photographer

Trish Symons
Judy James

Youth Section

Horticulture

Nancy Gerrard

Design

Roz Titley

Staging

Karen Morgan
Joyce Johnson

Photography Section

Chair

Rosemary Passafiume-McLean

Volunteer at Canada Blooms and see the show as our guest.

Help us ensure Canada Blooms and The Toronto Flower Show continue to be the best flower and gardening event in Canada.

The **Toronto Flower Show** (formerly Garden Hall) needs volunteers for the following:

1. 3 hour shifts helping visitors enjoy our show.
Contact: Ann Moffatt at bridgeview@sympatico.ca
or Dora Nasr at dnasr06@yahoo.com
2. Judges clerks to assist during judging.
Horticulture Section contact: Libbi Scully at
escully@look.ca or Janet Kennish at
jkennish@sympatico.ca
Design Section contact: Mandy Macrae at
wgmacrae@rogers.com

Canada Blooms also requires volunteers for 3 hour shifts. Volunteers will be assigned duties throughout the show including shifts in The Toronto Flower Show

Please register on-line at www.canadablooms.com or call the Canada Blooms office at 416 447 8655

WHY NOT GET ON A BUS ?

Rest and ride on your way to

Canada Blooms

Invite fellow club members, family or friends to
Canada Blooms and take advantage of Canada
Blooms' incredible group discount rate.

Hire a bus and driver and enjoy a day at Canada's
best flower and garden show. Invite a neighbouring
horticultural society or garden club and share costs.

Need help planning your trip? Call Canada Blooms
for: ticket information, bus operators in your area and
restaurant planning.

Call Canada Blooms
to make sure your group is on our mailing list

For more details call Tour Co-ordinator at
416-447-8655 or 1-800-730-1020 (toll-free in Canada)
or e-mail: info@canadablooms.com
Fax: 416-447-1567 www.canadablooms.com

Contents

Dates/Tickets.....	1
Letter from Canada Blooms Co-Chairs.....	2
“The Magic of Spring” The Toronto Flower Show.....	3
Organization.....	3
General Rules.....	7
Judging Criteria.....	9
 Horticultural Competition.....	 10
Competition Rules.....	10
Competition Schedule.....	14
Design Competition.....	20
Competition Rules.....	20
Competition Schedule.....	22
Awards.....	29
The Garden Club of Toronto Awards.....	29
General.....	29
Horticultural.....	29
Design.....	30
International Design Award.....	32
Open Class Awards.....	32
Horticultural.....	32
Design.....	32
 Youth Competition.....	 33
 Photographic Print Competition.....	 36
 Blank Forms (loosely inserted in centre of booklet)	
Horticultural Registration	
Horticultural Entry	
Photography Entry	
Ticket Order Form	

General Regulations

Entries

1. All Exhibits must be kept in show condition. Plant material must be kept fresh for the duration of the show.
2. No exhibit may be altered in any manner after it has been judged.
3. Maintenance may be done at any time, including opening hours. Please ensure that you are wearing appropriate ID.
4. Show management may remove an exhibit if deemed necessary.

Removal of exhibits

5. All exhibitors are responsible for guarding their exhibits on Sunday, March 24, 2013 from 5.00 p.m. until removal.
6. All exhibitors in the Exhibition Hall must wear proper identification at entry and maintenance times.

Photographs

7. No tripods may be used to take photographs at Canada Blooms, except by accredited media and the official show photographers. If you wish to have any professional photographs taken of your exhibit, please contact any of the show official photographers whose names and phone numbers will be posted at the show office.

Signs

8. The only signs permitted will be provided to the exhibitor by the management to ensure uniformity. It is the responsibility of the exhibitor to provide management with all pertinent information.

Safety

9. All material used for backgrounds and drapes must be flame-retardant.
10. Personal safety equipment is required on the Show floor before 9.30 a.m., Friday, March 15, 2013.
11. All exhibitors must comply with local fire regulations. Only fireproof materials may be used in displays and electrical wiring must conform to CSA or UL specifications. Fire exits and aisles must be kept clear at all times. The exhibitor assumes full responsibility for ensuring that exhibits meet these standards.
12. Exhibitors must guard against leaks and over-watering. Pool and fountain liners must be constructed of material strong enough to prevent seepage.

Nomenclature & Endangered Species

13. All plant material must be listed correctly. (See Helpful Hints on page 13 for reference).
14. Endangered and threatened species are strictly forbidden in any Canada Blooms Flower Festival exhibit. It is the responsibility of the exhibitor to make sure these plants are not on exhibit. The authority for determining the designation of any plant as an endangered or threatened species in the *Species at Risk Public Registry*. See: www.sararegistry.gc.ca/species/default_e.cfm . and www.cosewic.gc.ca .

Damages

15. Where exhibitors are responsible for damage to any part of the Exhibition Hall, the costs of repair will be charged to them.

Liability

16. While Canada Blooms will exercise due caution in safeguarding exhibits, it cannot assume responsibility for injury or loss. Valuables used in exhibits are to be insured by exhibitors.
17. LIMITATION OF MANAGEMENT'S LIABILITY. Exhibitor will make no claim against Canada Blooms, The Garden Club of Toronto, Landscape Ontario or the Direct Energy Centre (or their employees, directors, officers, agents or assigns) and agrees that management shall not be liable for any injury or loss or damage to exhibitor, or to its employees, agents, property or business caused by: (a) acts or omissions of any contractor (or employees of agents of such contractors) retained by management to perform services in connection with the Show or (b) fire, theft, destruction or any other occurrence not resulting from intentional misconduct on the part of the management (or their employees, directors, officers, agents or assigns), whether occurring during Show hours or the period designated for installation, maintenance and removal of exhibits, and not withstanding any negligence of management (or their employees, directors, officers, agents or assigns) connected therewith.
18. INDEMNIFICATION FOR EXHIBITORS' ACTS. Exhibitor agrees to indemnify and save harmless: Canada Blooms, The Garden Club of Toronto, Landscape Ontario or the Direct Energy Centre (or their employees, directors, officers, agents or assigns), and each of them, from any and all claims of liability made by anyone for any loss, injury or damage to persons or property, including death, arising out of the conduct of exhibitor or its employees or agents, and agrees to defend Canada Blooms, The Garden Club of Toronto, Landscape Ontario or the Direct Energy Centre against any such claims or liabilities and to reimburse them for all expenses, including costs of settlement, incurred in connection therewith.
19. By entering an exhibit in Canada Blooms, the exhibitor agrees to abide by and be governed by the conditions set forth in the foregoing rules.

Amendments

20. Canada Blooms shall have full power in the interpretation and enforcement of all rules contained herein, and the power to make such amendments thereto, and such further rules and regulations as it shall consider necessary for the proper conduct of the Show.

Judging Criteria

1. All Design and Horticultural exhibits shall be judged by a designated team of judges selected by the Canada Blooms Judges' Convenors.
2. Judges will not be permitted in the show hall during installation.
3. No one other than those authorized by the Show Committee will be permitted into that area of the show hall where judging is in progress and no one may discuss the exhibits with the judges prior to judging.
4. Designs must not be altered in any manner after judging. Deteriorating plant material however, must be replaced in order to keep the exhibit in show condition.
5. In Horticulture classes, no further subdivisions may be made, once judging commences.
6. The decision of the Judges shall be final.

See Helpful Hints for Horticultural Competitions on page 13

Horticultural Competition Rules

The following rules apply to all Horticultural Competitions.

1. Regulations and Judging Standards

General Regulations (pages 7-8), Judging Criteria (page 9) and the *Ontario Judging and Exhibiting Standards for Horticulture and Floral Design*, OJES 2003 edition.

2. Possession

All plants exhibited must have been grown by the exhibitor for at least 3 months prior to March 14, 2013 except in classes **24-33**. All bulbs and branches must be forced by exhibitor in classes **16, 17** and **18**.

3. Horticultural Forms

Horticultural Registration Forms and Entry Forms are provided with this schedule. Additional forms are available at The Garden Club of Toronto monthly meetings and Canada Blooms offices. All completed forms must be legible, accurate and clearly printed in BLOCK LETTERS.

- a) **Pre-Registration Forms** must be received at the Canada Blooms office by March 1, 2013. Mail, fax or e-mail submissions are all acceptable. See back cover for information on addresses and numbers. **Registration of additional entries** is also allowed on site on ENTRY DAY. Pre-registration is strongly encouraged because it is faster to delete an entry on that busy entry day than to enter new data
- b) **Entry Forms** must be printed clearly, including both botanical and common names of specimens where applicable. All plant lists must be included with the Entry Form. See Rule 4c. The entry card on display during the show is prepared from the information provided on this form.

4. Entries

- a) Exhibitors may have up to **THREE entries per class**; they must be of a different species or cultivars of a species.
- b) In Classes **1 – 15** inclusive and Classes **17- 22** inclusive, there may be one or more plants in each pot if of the same cultivar. Saintpaulia (African violet) is the exception, where only the trailing type or species are allowed to have multiple crowns. See OJES.
- c) **Exhibitors may have no more than 30 entries in total**. On each entry day, **each entry** must be accompanied by its own **Entry Form** with the exhibitor's name and class number, as well as the botanical and common names attached to the exhibit.
- d) For any entry that has special needs, the exhibitor must attach instructions including watering requirements. The water/grooming committee will be notified of these needs.

- e) **Plant lists:** If you are entering a class which permits two or more species or cultivars, Classes **4,8,9,11,13,** and **23 -33** inclusive, you must submit a plant list with your Entry Form. You must list, in legible form, all the plants with botanical and common names if possible, on index card stock, 10 x 15 cm (4"x6"), as well as on the **Entry Form. No accessories are permitted in horticultural classes** unless otherwise stated.
- f) All specimen plants should be free of top dressing with the exception of those in the Cactus and Orchid classes where pebbles, stones, sand, etc. (cactus), bark, Spanish, Sphagnum or sheet moss (orchids) is permitted.
- g) Where a class exists for a special type or variety of specimen, a specimen entry must be exhibited in that class, e.g. ferns must be exhibited in a fern classes. Class **19**, Novice Class and Classes **21** and **22** are exempt from this rule.
- h) For all horticultural classes, excluding Special Exhibits, an exhibitor may enter the same class on the 1st and 2nd entry day, provided their entry/entries are completely different cultivars or species. For classes calling for multiple cultivars or species, e.g. Class 23, the 2nd day entry may not include any of the cultivars or species in the exhibitor's 1st day entry.

5. Entry Dates/Times

First Day entries: Hours	Wednesday, March 13, 2013 4:30 pm to 7:30 pm
Second Day entries: Hours:	Tuesday, March 19, 2013 8:00p.m. - 10:00 p.m.

Please Note that ALL CLASSES have 2 ENTRY DAYS this year

6. Classification

- a) A member of the Classification Team must initial each **Entry Form** before the exhibitor places the exhibit on the show floor.
- b) The Classification Team may, at its discretion, refuse to accept an entry if it is not considered to be of show quality, or not free from pests and disease.
- c) **Please Note:** No competitor will be allowed to groom or water her entry after it is placed on the show floor until Judging has been completed. The Show Committee may allow entrants to cover their entries if temperature and/or dust conditions would damage plants. Covers will be removed before judging by members of the show committee.

7. Staging

- a) The Show Committee may subdivide classes and may move or remove entries if necessary before judging commences.
- b) All exhibits must be kept in show condition. Exhibitors are responsible for maintaining and watering their entries AFTER JUDGING HAS TAKEN PLACE, unless they have notified the Horticulture Chair. See Rule 4d. Plant material must be kept fresh for the duration of the show. Work may be done any time during the show, including public open hours.

8. Judging Dates/Times

First Day: **Thursday, March 14, 2013, 1:00 p.m**

Second Day: **Wednesday, March 20, 2013, 9:30 a.m.**

9. Removal

Exhibitors are responsible for and must remove their exhibits according to the schedule listed below..

All classes entered on First Entry Day must be removed Tuesday, March 19, 2013 between 7:30 and 8:00 pm.

All classes entered on Second Entry Day must be removed Sunday, March 24, 2013 between 5:00 and 5:45 p.m.

No boxes or other removable containers are permitted on the show floor prior to removal times as set out above.

10. Pot Size

Refers to the inside measurement of the container, at the top, in which the plant is grown. Measure along the dotted lines as shown in the following diagrams:

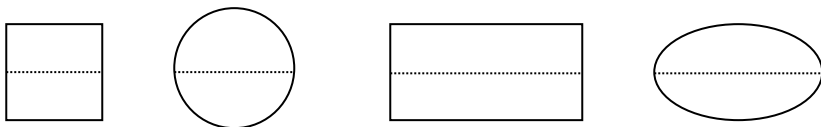

HELPFUL HINTS FOR THE HORTICULTURAL COMPETITIONS

Please check *Ontario Judging and Exhibiting Standards for Horticulture and Floral Design* (2003 edition), also known as OJES.

The following are a few of the criteria the judges take into consideration when judging:

- When there is more than one specimen of the same cultivar in an entry, the judge looks for uniformity in size, form, colour and stage of development as well as cultural perfection.
- Freshness of material, along with the proportion of the stem to the cultivar and condition of the foliage, where applicable, are looked at carefully.
- Floriferousness refers to the abundance of flowers on the entire plant. The quality of colour and size as well as the number of flowers, is of importance.
- Good condition and grooming are important, and all entries must be free of pests and disease. Any damaged foliage should be carefully removed so that it does not affect the overall appearance of the exhibit.
- It is important for the exhibitor to check in *Ontario Judging and Exhibiting Standards for Horticulture and Floral Design* (2003 edition), also known as OJES, for the Scale of Points for each type of exhibit, e.g. Flowering Branches have a Scale of Points that is quite different than that for Cacti and other Succulents. By checking in this publication, you could end up with the winning entry! It is really a "must do".
- Saucers of compatible material should be brought with potted plants and placed under them for drainage.
- Reference books that might be of assistance are:
Reader's Digest A-Z Encyclopedia of Garden Plants - Brickell, Cole, Zuk
The Reader's Digest Success with Houseplants
Encyclopedia of Herbs & Their Uses – Bown
- **Remember to read your schedule carefully – it is the law of the show.**

You will need to complete two types of forms, enclosed with this schedule.

1. Horticultural Registration Form (1 per exhibitor)

This form can be completed and submitted for pre-registration (March 1, 2013), or you may register on-site during the entry times. The form must contain the exhibitors' names and club affiliations, if any. This form lists all the entries you are submitting for **both entry days**. A copy of this form will be available at the pre-register desk on the show floor, and this information will have been entered into the show database. On entry days, you must notify the Entries Convenor in the Hort office of any entries that are added or deleted.

2. Entry Form (1 per entry)

This form must be attached to **each entry** and is not to be pre-submitted. It allows the show committee to identify the owner of each plant or entry until the printed forms are completed from our database. If you are entering an **"Exhibit"** in **Section E, F or G** you must attach to your entry a printed list of plants with both botanical and common names to your entry. This must be on a 10x15 cm (4"x6") card or paper that can be cut to fit the holders placed on the show floor with your entry.

Note: These forms can be copied from the schedule or downloaded from the website www.canadablooms.com . Also, they will be available on the entry days at the Registration tables.

If you have more than 10 entries, please arrive at least one hour and a half prior to the close of entries on Wednesday, March 13, 2013 and Tuesday, March 19, 2013. No entries will be allowed after that time.

Exhibitors may enter the show floor any time after 2:30pm on Wednesday, March 13, 2013 to begin preparing their entries, but entries will not be classified or accepted until 4:30pm.

Horticultural Competitions

Note: There are two entry days for all classes.

Open Classes

Sections A, B and C are open to all interested non-professional exhibitors and all members of horticultural societies and garden club members including The Garden Club of Toronto

SECTION A: POTTED PLANTS (GENERAL)

Class 1 Flowering or Fruited plant(s), 1 cultivar, pot any size.

Class 2 Foliage plant(s), 1 cultivar, variegated, pot any size.

Class 3 Foliage plant(s), 1 cultivar, non-variegated, pot any size.

Class 4 Foliage plant(s), 2 of the same species, one variegated and one non-variegated, in separate pots of the same size.

Convenors: Carolyn Mc Robie 416-972-1069

Judy McMartin 416-487-2051

Class 5 Hedera helix, any cultivar, trained on an open frame by exhibitor, pot any size.

Convenor: Susan Hart 416-322-8460

Herbs

Class 6 Pelargonium (Scented Geranium), 1 cultivar, pot any size

Class 7 Culinary herb, 1 cultivar, pot any size.

Convenors: Jane Persson Morley 905-726-8523

Linda Davis 416-781-6646

SECTION B: POTTED PLANTS (SPECIFIC) AND SPECIMEN PLANTS

Class 8 Two Rex Begonias, named, in separate pots, pots any size

Convenors: Derryn Gill 416-221-6697

Anne Cook 416-486-7733

Class 9 Two Gesneriads, named, growing in separate pots. (e.g. Aeschynanthus, Columnea, Episcia, Saintpaulia, Sinningia, Streptocarpus) Pots any size.

Class 10 Miniature Saintpaulia (African Violet), in appropriately sized pot.

Note: A miniature has a leaf span of 15cm (6") or under. See OJES page 29.

Convenors: Joan Bostock 416-222-5575

Jane Pask 416-488-4361

Class 11 Three Ferns, all different cultivars, growing in separate pots. On exhibitor's own tray.

Convenor: Louise Golding 416-480-9918

Note: Orchids may be top dressed. Orchids may be staked. See rule 4f.

Class 12 Orchid, 1 species or cultivar, pot any size.

Class 13 Orchids, 2 or more species or cultivars, growing in separate pots. On exhibitor's own tray.

Note: Orchids may be top dressed. Orchids may be staked. See rule 4f.

Convenors: Gunnel Brandkvist 416-485-9307

Sheilah MacDonald 647-347-0060

Note: No grafted cacti are permitted. See rule 4f.

Class 14 Cactus, 1 cultivar, pot any size.

Class 15 Succulent(s) (other than cactus), 1 species or cultivar, pot any size.

Convenors: Janet Marsh-Frosst 416-485-7417

Elaine Hill 416-486-9517

SECTION C: FORCED BRANCHES AND BULBS

Class 16 One flowering branch, any length, cut and forced by exhibitor, in exhibitor's own container. State date cut.

Class 17 Hardy flowering bulbs, corms, or tubers (e.g. Tulip, Crocus, Hyacinth, Iris reticulate, Hardy Narcissus). One cultivar, minimum of five in one container.

Class 18 Hippeastrum (Amaryllis), 3 bulbs in a pot, 1cultivar, grown in soil. May be staked. Pot any size.

Convenors: Marilyn Olivares 905-731-7604

Frankie Wright 416-483-3690

The Garden Club of Toronto Classes

Sections D, E and F are open to members of The Garden Club of Toronto only.

SECTION D: EDUCATION

Novice Class (Class 19) is open to any member who has not won a red ribbon in a horticultural class in any major Garden Club of Toronto Show/ Canada Blooms Flower Show (excluding monthly Percy Band and Peg Farwell competitions).

Class 19 Foliage plant(s), 1 cultivar, pot any size.

Convenor: Catharine Carroll 416-322-3440

Challenge Class

Class 20 Herbaceous perennial, forced into growth from exhibitor's garden. Pot any size.

Note: The perennial could be dug up in the fall, potted, and kept in a cool place until you decide it is time to force it.

Class 21 A mature plant and its offspring, growing in separate pots. Name and propagation method to be stated.

Class 22 Wonderfully Weird, an interesting and unusual plant, any cultivar, pot any size.

Convenors: Margaret Betts 416-699-3597

Karen Trotter 416-545-0511

Class 23 A collection of fresh, cut plant material, minimum 3 different cultivars, from exhibitor's own garden, in exhibitor's own container. Botanical and common names should be listed.

Convenors: Amanda Frohman 416-968-7749

Joan Law 416-921-4805

SECTION E: SPECIAL EXHIBITS

Note: See OJES pages 74 – 75. Special Exhibits for Open Classes, see **Section G**. Appropriate convenors should be notified in advance as to which entry day you would like. All exhibits in Sections E, F, and G should have a list of botanical and common names.

Class 24 Abracadabra. A miniature landscape, an exhibit where a scene in nature is realistically and intentionally reproduced. Scale is of utmost importance. Container not to exceed 60cm (24") in any direction. Plants may be newly acquired. Accessories permitted.

Convenor: Ellen Clark 416-486-9352

Class 25 Presto. A basket of compatible rooted foliage and/or flowering plants. Plants may be newly acquired. Basket any size. Accessories permitted.

Convenor: Joyce Johnson 416-483-6939

Class 26 Thaumaturgy. Container(s) planted with compatible plant material, may include fresh cut flowers and/or foliage and/or branches. To incorporate an organic or inorganic structure. Plant material may be newly acquired. Accessories permitted. May be created by one or two people. Staged on a base 122cm square x 15cm high (48x48x6"). Limited to 4 entries each day. Colour of base is Sweet Pea (Benjamin Moore 2031-30)

Convenor: Joyce Moffat 416-445-0813

Class 27 Bursting. Two items of footwear (may be different), containing compatible rooted plant material. Plants may be newly acquired. Accessories permitted.

Convenor: Sue Schaal 416-922-7875

Class 28 Wizard. A number of compatible rooted plants growing in a planter. Cut flowers and/or foliage and/or fresh or dried branches may be used. Plant material may be newly acquired. Accessories permitted. Staged on a faux stone pedestal.

Convenor: Sue Schaal 416-922-7875

SECTION F: SPECIAL EXHIBITS -HERBS

Note: Herbs should be named and use(s) stated, with common and botanical names.

Class 29 Stepping Out. A fascinator decorated with fresh and/or dried cut herbs, accessories permitted. Plant material must predominate and may be newly acquired. Styrofoam head form, painted dark purple, will be provided.

Class 30 Sorcery. Herbs planted in a container not traditionally used for planting. Herbs may be newly acquired. Accessories permitted.

Class 31 Magic. Healing herbs, medicinal herbs planted in a container. Herbs may be newly acquired. Accessories permitted.

Convenors: Trudy Grantham 416-691-5333
Cathy Broughton Marshall 905-882-8528

SECTION G: SPECIAL EXHIBITS – OPEN CLASSES

Open to all interested non-professional exhibitors and all members of horticultural societies and garden clubs other than the Garden Club of Toronto. May be done by one or two people.

Class 32 Awakening. A birdbath containing compatible, rooted plant material. Fresh cut and/or dried plant material allowed. Plants may be newly acquired. Accessories permitted.

Convenor: Margaret Taylor 416-440-1344

Class 33 Exuberant. A window box planted with compatible rooted plant material. Plants may be newly acquired. Accessories permitted. Container to be supplied 72cm wide x 27cm high x 25cm deep (28.5x6.5x6").

Convenors: Pat Cappelli 416-296-0402
Diane Wilton 416-498-7921

Design Competition Rules

The following rules apply to all Design Competitions. Note that only non-professionals may compete.

1. General Regulations (pages 7-8), Judging Criteria (page 9) and the *Ontario Judging and Exhibiting Standards for Horticulture and Floral Design* (2003 edition) apply.
2. Exhibitors are requested to notify Convenors as soon as possible, which dates and classes they wish to enter. Do not wait to be called. Space will be reserved for each exhibit upon receipt of the completed Non-Professional Design Registration form, or when notice is received by letter or telephone. **Exhibitors unable to fulfill their responsibility must find their own substitute.**
3. Exhibitors may enter any number of classes, but may submit only one exhibit in each class.
4. All classes are limited to 5 exhibits each entry day except where noted in the Schedule.
5. First day exhibits will be received between 7:00 a.m. and 12:30 p.m. on Thursday, March 14, 2013. First day exhibits must be removed at 7:00 p.m. on Tuesday, March 19, 2013.
6. Second day exhibits will be received between 8:00 p.m., Tuesday, March 20 and 1:00 a.m., Wednesday, or between 7:00 a.m. and 9:00 a.m. on Wednesday, March 20, 2013.
7. All designs must be in place and ready for the Passing Committee at the following times:

Thursday, March 14, by 12:30 p.m. for judging at 1:00 p.m.

(They must remain in place until Tuesday, March 19 at 7:00 p.m.)

Wednesday, March 20 by 9:00 a.m. for judging at 9:30 a.m.

There will be a warning bell 15 minutes prior to the time of clearing the judging area on both entry days.

8. All exhibits must be removed promptly on Sunday, March 24 at **5:00 p.m.** Failure to do so will result in the exhibitor being billed for the cost of removal.
9. International Flower Show Rules, World Association of Flower Arrangers (WAFA) will apply.
 - An exhibit is made of plant material, with or without accessories, within a space specified in the Show Schedule.

- Plant material must predominate over all other components of the exhibit.
- The use of artificial plant material is forbidden unless stated in the regulations.
- Fresh plant material must be in water or in water-retaining material unless such material remains turgid throughout the event.
- Painted and/or artificially coloured plant material may be used unless otherwise stated in the regulations.

10. **All designs must be made and staged by the exhibitors themselves. Any competitor receiving help with put-in other than help that is physically necessary will be disqualified.**
11. All exhibitors are asked to leave their completed entry sheet with their entry at the time of entry. It should include: name, class, date, a list of material in the design, including both common and botanical names and explanation of containers of interest. See *Snippy Tips #1*. **Novice designation must be included on the entry sheet.** The list of material in the design should be duplicated, in block capitals or typed to be available for the judges.
12. Check with your class convenor to see that your entry meets all requirements set out in the schedule. **A design which does not comply will not be judged.** This will be at the sole discretion of the Design Committee Chair. ***You may not leave the design area until your entry is accepted by the Passing Committee.*** This will be indicated by the letter **P** marked on your entry card.

Regarding liability - see General Regulations page 8.

Scale of Judging Points

(except where otherwise stated)

Design: Organization of the elements and principles	35 points
Conformance: Compliance with scheduled requirements, theme	25 points
Creativity: Originality of concept in choice of components, and/or organization of design elements according to the principles of design	20 points
Distinction and Condition: Marked superiority and physical state of plant material at time of judging	20 points

Scale of Points for Tables: see *Ontario Judging Standards* (2003 edition)

Scale of Points for Miniatures: see *Ontario Judging Standards* (2003 edition)

Deductions will be proportionate to the degree of non-compliance.

Design Competitions

"THE MAGIC OF SPRING"

The Garden Club of Toronto Classes

Open to members of The Garden Club of Toronto

NOVICE CLASS

Open to members of The Garden Club of Toronto who have not previously won a red ribbon in any major Garden Club of Toronto Show or Canada Blooms Show (excluding monthly Neil Cup and Margaret Dove competitions)

Class 101 Charming

A table centerpiece

Staged: on a solid pedestal 91.5cm high with a 30cmsquare top (36"x12"x12"), mounted on a base 91.5cmx91.5cmx15cm high (36"x36"x6") against a background panel 91.5cm wide x 183cm high (36"x72")

Area Allotted: 91.5cmx91.5cmx183cm (36"x36"x72")

Background, base and pedestal colour:
Mystical Grape *2071-30

Convenors: Donna Buss
Janet Marsh Frosst

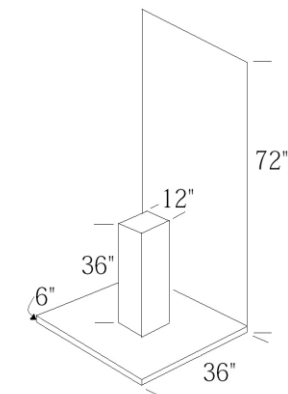

416-446-2843
416-483-4714

Class 102A Wondrous

102B A design

**Entry
Day 2
only**

Staged: on a base 122cmx122cmx10cm high (48"x48"x4") against a background panel 122cm wide x 244cm high (48"x96")

Area Allotted: 122cmx122cmx244cm (48"x48"x96")

Background and base colour:
Sweet Pea *2031-30

Convenor: Sue Schaal

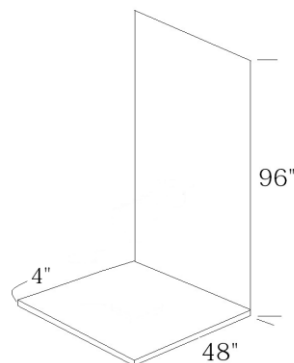

416-922-7875

* Benjamin Moore paint number

Class 103 Magnetic

A synergistic design

Staged: on a floating shelf 122cm wide x 61cm deep (48"x24") at a height of 91.5cm (36") against a background 122cm wide x 213cm high (48"x84"). Design may trail below the shelf

Area Allotted: 122cm wide x 61cm deep x 213cm high (48"x24"x84")

Background and shelf colour:

Sweet Pea *2031-30

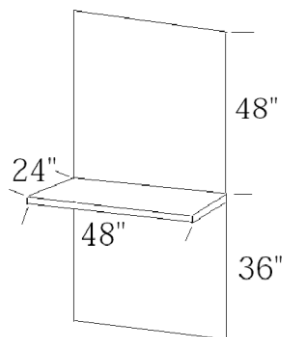

Convenors: Joyce Moffat
Linda Alcock

416-445-0813
416-481-9894

Class 104 Enchanting

A functional table

Note: Objects may be hung from the top of the wall, however, nothing is to be placed on the ground.

Staged: on a round table 99cm in diameter x 74cm high (39"x29") on the ground, against a wall 122cm wide x 244cm high (48"x96")

Area Allotted: 122cmx122xmx244cm (48"x48"x96")

Background colour: Mystical Grape
*2071-30

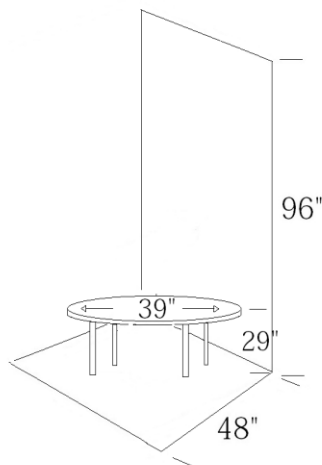

Convenors: Sue Schaal
Heather Bosman

416-922-7875
905-877-1533

Class 105 Bewitching

A miniature design using fresh plant material. Design not to exceed 12.5cm (5") in any dimension.

Design may be hung

Staged: in a mounted acrylic box 13.4cm wide x 15.2cm high x 13.4cm deep (5.25"x6"x5.25") mounted 140cm (55") from the floor. A matte will be affixed to the inside back wall of the box.

Set colour: Sweet Pea *2031-30

Matte Colour: Sample to be supplied

Convenors: Jackie David 416-487-5231
Amanda Frohman 416-968-7749

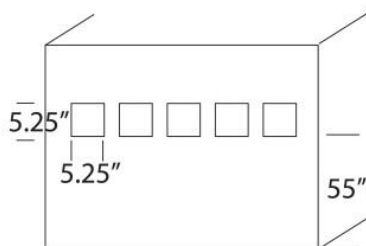

Class 106 Entrancing

A miniature design using dried plant material. Design not to exceed 12.5cm (5") in any dimension.

Design may be hung

Staged: in a mounted acrylic box 13.4cm wide x 15.2cm high x 13.4cm deep (5.25"x6"x5.25") mounted 140cm (55") from the floor. A matte will be affixed to the inside back wall of the box.

Set colour: Mystical Grape
*2071-30

Matte Colour: Sample to be supplied

Convenors: Loris Adamson 905-655-7139
Rosemary Passafiume-McLean 416-284-6959

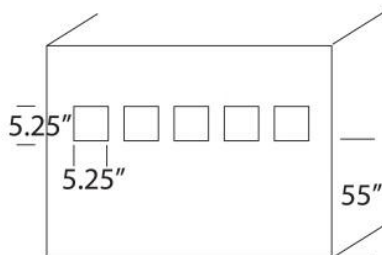

Class 107 Awesome

An abstract design

Staged: in a niche. Design may be hung. Nothing to be attached to the walls.

Area Allotted: 111.5cm wide x 81cm deep x 142 cm high (44"x32"x56")

Niche colour: Sweet Pea *2031-30

Set colour: Mystical Grape *2071-30

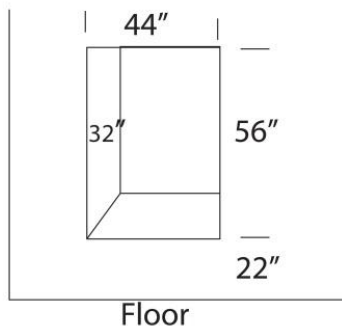

Convenor: Trudy Grantham
Diana Kennedy

416-691-5333
905-983-1187

Class 108A Devilish

108B A cake (any flavour) made of plant material

Staged: on a 30cm (12") round tube topped with a disk 46cm (18") in diameter. Height: 5 entries at 91.5cm (36") and 5 entries at 107cm (42").

Area Allotted: 91.5cm wide x 91.5 cm deep (36"x36"). No height restriction.

Tube and disk colour:
Sweet Pea *2031-30

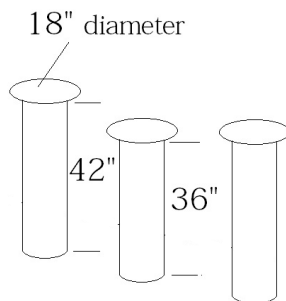

Convenors: Judy James
Trish Symons

416-960-2010
519-941-2175

Class 109 Bedazzling

A modern mass

Staged: on a black wrought iron pedestal 91.5cm high 30.5cm square top (36"x12"x12") on a round base 122cm x 10cm high (48" x 4") background is 122cm x 244cm (48" x 96")

Area Allotted: 122cm x 122cm x 244cm (48" x 48" x 96")

Base and background colour:
Mystical Grape *2071-30

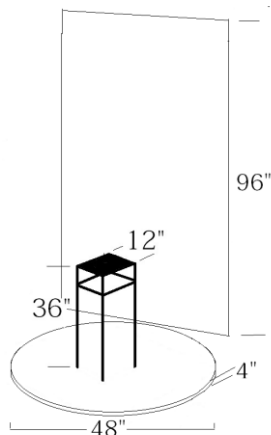

Convenors: Judy Zinni
Sandra Williamson

905-820-3807
519-855-9552

OPEN CLASSES

Open to all members of garden clubs and horticultural societies
including The Garden Club of Toronto

Class 110A Spellbinding

110B A design to suggest a piece of jewellery using dried and/or treated plant material, equipped to hang on a wall. (A judicious amount of dyed and/or painted material permitted.)

Entry Day 1 only – to remain in place for 10 days.

10 entries

Staged: The design should be contained within the display board. 46cm x 46cm (18" x 18") Entry must be equipped to hang.

Area allotted: 46cm x 46cm (18"x18")

Background colour: Mystical Grape 2071-30

Display board colour:
Cotton Balls *2145-70

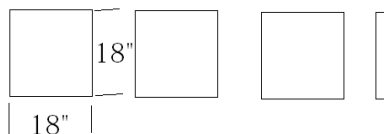

Convenors: Lynda Summerville
Ursula Eley

416-690-5434
416-699-4353

* Benjamin Moore paint number

Class 111 Magical

A collage, an abstract design. (See OJES).

An unframed, low-relief design of dried, pressed and/or preserved plant material, equipped to hang on a board (28"x28") either vertically or horizontally. Not to exceed 61cm x 40cm (24"x16") and not less than 35.5cm x 30.5cm (14"x12"). Maximum depth of design: 5cm (2").

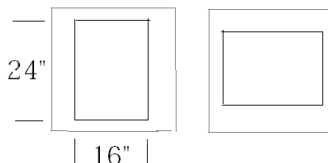

Note: Entries must be received or registered by February 15, 2013, and removed on Sunday March 24, 2013 at 5:00p.m.

Background colour:

Mystical Grape *2071-30

Board colour:

Cotton Balls *2145-70

Convenors: Irina Code

Lynda Summerville

519-660-1823

416-690-5434

Open to all members of garden clubs and horticultural societies *other than* The Garden Club of Toronto.

Class 112 Houdini

A design incorporating metal

Staged: on a pedestal 30cm square and 91.5cm high (12" x 12" x 36") on a base 122cm x 122cm x 5cm (48" x 48" x 2") **Background** is 122cm x 213cm (48" x 84").

Area Allotted: 122cm x 122cm x 213cm (48" x 48" x 84")

Background, base and pedestal colour: Mystical Grape *2071-30

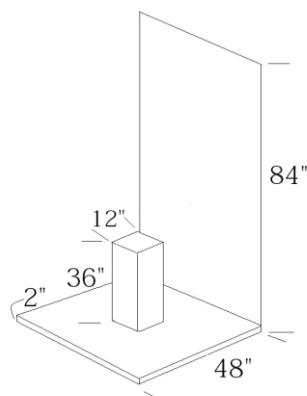

Convenors: Brigitte Ballhausen
Lil Taggart

416-927-8711
289-891-9668

INTERNATIONAL CLASS

Class 113 CAPTIVATING

**Entry
Day 1
only**

A design

Staged: on a base 122cm x 122cm x 10cm high (48"x48"x4") against a background panel 122cm wide x 244cm high (48" x 96")

Area Allotted: 122cm x 122cm x 244cm high (48"x48"x96")

Base and Background colour:

Sweet Pea *2031-30

Note: Exhibits to remain in place until 7pm on March 19.

Exhibitors may view the set Wednesday, March 13 but no installation is to take place before 7:00 a.m. Thursday, March 14.

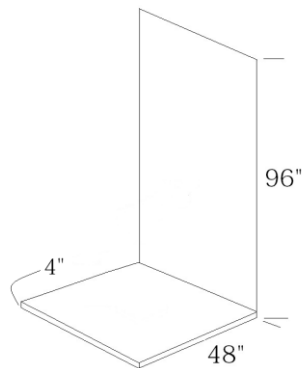

Convenor: Margaret Taylor 416-440-1344

IKEBANA CLASS

Class 114 AWAKENING

Ikebana design

Staged: on a pedestal 76cm (30") high with a 46cm (18") square top against a background 91.5cm wide x 183cm high (36"x72")

Area Allotted: 91.5cm x 91.5cm x 183cm (36"x36"x72"). Design may extend below the top of the pedestal.

Background and pedestal colour:

Sweet Pea *2031-30

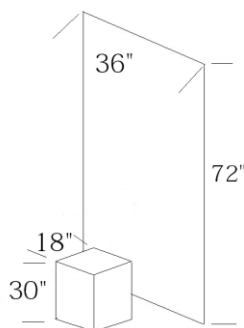

Convenors: Sue Clarkson
Saskia Kessler

416-763-3918
416-445-6731

Flower Show Awards

Awards will be presented on the show floor on Sunday, March 24, 2013, at 3:00 p.m.

On the show floor all award winning entries are given a Green Ribbon.

General Awards

1. **Kathy Dembroski Awards**, for Judges' Choice for: (a) an entry with the most fascinating and intriguing design in **Design**, in any Design Class excluding the International Class and (b) an entry with the most fascinating and intriguing design in **Horticulture**, Sections A to G inclusive.

The Garden Club of Toronto Awards

Open to members of The Garden Club of Toronto

General

2. **The Libra Award**, to the exhibitor who wins a first in Design as well as in Horticulture. In Horticulture, no classes with newly acquired plant material are to be considered. Herb classes and Educational classes are eligible as long as they do not include newly acquired plant material. Only one competitor may win this award.
3. **Upper Canada House Award**, for the best interpretation of the theme of the show. All classes are eligible.

Horticultural

Scale of Points

Green Ribbon (Award winning entry)	2 points
First	6 points
Second	4 points
Third	2 points
Honourable Mention	1 point

4. **Green Thumb Award**, Judges' choice for the exhibit demonstrating outstanding horticultural skills. All Horticultural classes in Sections A, B and D are eligible
5. **Anniversary Award**, for the highest aggregate number of points in Sections A, B, C and D in the Horticulture classes.
6. **Helen Cochrane Novice Award**, for the best exhibit in Class 19 by a member of The Garden Club of Toronto who has not previously won a red ribbon in a Horticultural class at our annual show.

7. **Jane McArthur Award**, for the best exhibit in a class that is both educational and challenging, in Classes 16 to 18 inclusive, and 20 to 22 inclusive.
8. **Ridpath Award**, for the best exhibit in Classes 1 to 23 inclusive.
9. **William Neilson Award**, Judges' Choice for the best exhibit combining design and horticultural excellence in Classes 24 and 25.
10. **The Garden Club of Toronto Horticultural Bowl**, for Judges' Choice in Class 26.
11. **Jane Donnelly Award**, for the best interpretive design in Horticulture in Classes 27 and 28.

Herb

12. **Elizabeth Bryce Award**, for the best exhibit in Herb Classes 29 to 31 inclusive.
13. **Evelyn Meagher Award**, for the highest number of points in the Herb Classes 6, 7, and 29 to 31 inclusive.

Note: The designation "Judges' Choice" gives judges the freedom to choose a particular exhibit. It is not necessarily one which won a first ribbon.

Design

Scale of Points

Green Ribbon (Award winning entry)	2 points
First	6 points
Second	4 points
Third	2 points
Honourable Mention	1 point

All Design classes are eligible for 1st, 2nd, 3rd and Honourable Mention ribbons with the following exceptions: Classes 111 and 113 which will be point scored and Gold, Silver, Bronze or Highly Commended rosettes will be awarded according to the points achieved. Class 114 is not to be judged.

14. **Founders' Gold Cup**, for creative works of *outstanding beauty* in a design which includes fresh plant material. Members may win the Gold Cup any number of times. Miniature designs, Table designs and Class 108 A & B, Devilish, Class 110 A & B, Spellbinding, and Class 111, Magical, are not eligible for the Gold Cup.

15. **The Katherine Hobbs Award**, for *distinctive design*. Open only to winners of the Founders Gold Cup and to members who have been contenders for the award since its inception (not including this show). Members may win the Hobbs Award any number of times. All competitive exhibits by Hobbs winners and contenders will be eligible each entry day. Miniature designs, Table designs and Class 108 A & B, Devilish, Class 110 A & B, Spellbinding and Class 111, Magical, are not eligible for the Hobbs Award.
16. **The Garden Clubs of Ontario Award**, Judges' Choice for the *most creative design* by the Garden Club member who has never been a contender for the Katherine Hobbs Award. Katherine Hobbs Award contenders for this show are not eligible.
17. **Helen Cochrane Award**, Judges' Choice for the *most distinctive design* by a member of The Garden Club of Toronto who has not previously won a red ribbon in a design class at our annual show, e.g. Canada Blooms. Novices must declare eligibility for this award to the Convenor at entry time.
18. **Joyce Girvan Award**, Judges' Choice for the *best mass design* in any class except the table class.
19. **The Garden Club of Toronto Silver Anniversary Rose Bowl**, Judges' Choice for the *most distinctive table setting* in Class 104.
20. **The Garden Club of Toronto Silver Trillium Award**, Judges' Choice for the *most distinctive miniature* design from Classes 105 and 106.
21. **TD Bank Group Award**, Judges' Choice for the *most distinctive design* in Class 108 A & B, Devilish.
22. **Madelyn Weir Foy Award** Judges' choice for horticultural excellence. All Design classes eligible.
23. **Camston Award**, awarded to the competitor with the highest aggregate number of points in the Design section obtained during the show.
24. **Award for Colour**, awarded for the best use of colour in the Design section.

International Design Award

25. **Johnston & Daniel International Award**, Judges' Choice in the International Class 113.

Open Class Awards

Horticulture

26. **Tommy Thompson Award**, for the best exhibit in Sections A and B, excluding any Garden Club of Toronto exhibitor.
27. **Canada Blooms Award**, best exhibit in Classes 1 to 4 inclusive.
28. **Canada Blooms Award**, best exhibit in Class 5.
29. **Canada Blooms Award**, best exhibit in Classes 6 and 7.
30. **Canada Blooms Award**, best exhibit in Classes 8 to 11 inclusive.
31. **Canada Blooms Award**, best exhibit in Classes 12 and 13.
32. **Canada Blooms Award**, best exhibit in Classes 14 and 15
33. **Canada Blooms Award**, best exhibit in Classes 16 to 18 inclusive.
34. **Garden Clubs of Ontario Award**, best exhibit in Class 32.
35. **Toronto Botanical Gardens Award**, Judges' Choice in Class 33.
36. **Canada Blooms Award of Horticultural Excellence** for the highest aggregate number of points for an Open Class exhibitor in Sections A, B, C and G, excluding members of The Garden Club of Toronto.

Design

37. **The Garden Club of Toronto Award**, for the *most distinctive design* in Class 112, Houdini.
38. **Canada Blooms Award**, for Judges' Choice in Classes 110 A & B, Spellbinding. All entries in these classes, including those by Garden Club of Toronto members, are eligible for this award.
39. **Canada Blooms Award**, for Judges' Choice in Class 111, Magical. All entries in this class, including those by Garden Club of Toronto members, are eligible for this award.

Professional Florist Award

Honourary Award in Recognition of a Professional Florist at Canada Blooms chosen for their contribution to the Toronto Flower Show. The Toronto Flower Show is pleased to present the 2013 award to Bruno Duarte of Fresh Floral Creations.

Youth Competition

General Rules

1. Each exhibitor must be 12 years or under in age as of March 14, 2013.
2. The Youth Competition is an open class (open to any child who meets the age requirement)
3. Exhibitors can have guidance from an adult, but the exhibitor will be very involved in the creation and execution or care of the entry.
4. Exhibits will not be judged, but each entry will receive a ribbon
5. All entrants will be invited on stage as a group to receive their ribbon during the Awards Ceremony

Removal

No entries may be removed until Sunday, March 24 at 5:00 p.m.
Exhibits must be removed by 5:45 p.m.

Horticulture Rules

1. Entries must be accompanied by an entry form that is included with this schedule or that can be downloaded from the Canada Blooms website. For Youth entries only, birth date must be stated on the entry form.
2. One entry per exhibitor or group of exhibitors.
3. Youth Horticulture entries are to be delivered to the Garden Club of Toronto Preparation Room at the Direct Energy Center during the first day entry time for the Horticulture Section: Wednesday, March 13, 2013 between 4:30 p.m. and 7:30 p.m.

OR

Contact Nancy Gerrard at 416-407-9793 or nancy-@sympatico.ca

Design Rules

1. An exhibit is made of predominately plant material, with or without accessories, within the allotted size.
2. Fresh plant material must be in water or in water retaining material unless the plant material otherwise will remain in good condition throughout the show.
3. Dried plant material is material from which moisture has been removed naturally or by artificial means.
4. Painted and artificially coloured material may be used.
5. The use of artificial, protected or locally invasive plant material is forbidden.
6. Entries must be accompanied by an entry form that is included with this schedule or that can be downloaded from the CB web site. For the Youth entries only, birth date must be stated on the entry form.
7. One entry per exhibitor or group of exhibitors.
8. Mail in entries are not returned unless the entry is picked up by the exhibitor as outlined below.
9. Youth Floral Design entry can be mailed or delivered and received by March 5, 2013. Mail to:

Roz Titley,
407 Merton St.
Toronto, ON M4S 1B4.

Entries may also be delivered directly to the Garden Club of Toronto Preparation Room at the Direct Energy Center during the first day entry times for the Floral Design Section.

OR

Contact Roz Titley at 416-487-9887 or titleys@rogers.com

Removal

No entries may be removed until Sunday, March 24 at 5:00 p.m.
Exhibits must be removed by 5:45 p.m.

Youth Horticulture Class

Class 1Y Herbology

A fruit or vegetable resprouted or rooted in the medium of the exhibitor's choice. One variety, pot or container any size.

Example: avocado pit rooted in water in a clear glass jar

Youth Design Class

Class 2Y Abracadabra

A bug made of dried plant material and equipped to stand.

Your design can represent a real bug, or one created by your imagination. Any type of dried plant material may be used, for example: seeds, leaves, flowers, bark. The plant material may be dyed or painted. Accessories are permitted.

Maximum dimensions: 20cm x 25 cm (8" x 10")

Displayed on: Cocoa Bean Hulls

Photographic Print Competition

Rules and Regulations

1. Open to all interested amateur exhibitors and all members of horticultural societies and garden club members including the Garden Club of Toronto.
2. Exhibitors may submit ONE entry in each class.
3. Prints must be 5 X 7 photographs, not framed or matted, no border.
4. All photographs must have been taken in Canada by the exhibitor and may not have been entered in a previous show.
5. Entries will be judged before the Show on standard criteria for judging photographs, such as: overall aesthetic quality, interpretation of the class title, composition, and quality of light and center of interest. Winner will be notified in advance.
6. Entries may be mailed or delivered to the office of the Garden Club of Toronto, 777 Lawrence Avenue East, Toronto, Ontario, M3C 1P2.
7. Entries must be accompanied by an entry form which is included with this schedule or can be downloaded from the Canada Blooms website.
8. Entries must be received in the office of the Garden Club of Toronto by Thursday, February 14, 2013.
9. Depending on the volume of entries received, the Photography Convenors reserve the right to display only those entries chosen.
10. If you wish your photo to be returned after the show, you must include a stamped, self-addressed envelope, which will accommodate the photo.
11. If you wish to pick your photo up at the end of the show please indicate your intention.
12. A label must accompany each entry. This label is to identify which way the photo is to be displayed, entrant's name, address and the class title and number. The label is to be secured to the top right hand corner of the back of the photo.
13. The Garden Club of Toronto or Canada Blooms will not knowingly use photos for purposes other than display at the Show. The exhibitor retains ownership of the image.
14. **It is the responsibility of the entrant to ensure that the photo is a 5 x 7 print, and that the label and the completed entry form are included with entry. Entries, which do not meet these requirements, will not be considered, displayed or returned.**
15. First, Second, Third and Honourable Mention ribbons will be awarded. There will be a prize awarded for the photo judged as Best in Show.
16. Reasonable Security will be supplied; however Canada Blooms assumes no responsibility for loss or damage.

Convenor: Rosemary Passafiume-McLean 416-284-6959

Rosemary.passafiume.mclean@gmail.com

Photographic Print Classes

Class 1 New Beginnings

Class 2 People in Motion

Class 3 Bugs and Butterflies

**Class 4 Canadian Landscapes, Seascapes
And Cityscapes**

Canada Blooms

Board of Directors Festival co-Chairs

Mary Lou Tigert
Arvils Lukss

Members

Heather Fuller
Marjorie Lenz
Joyce McKeough
Peter Guinane
Adam Bienestock
Warren Patterson
Jill Fairbrother
Michel Gauhtier
Mary Jane Lovering
Lawson Oates

Artistic Designer Colomba Fuller

General Manager Gerry Ginsberg

Executive Director Landscape Ontario Tony DiGiovanni

Landscape Ontario President Phil Charal

The Garden Club of Toronto President Janet Kennish

Canada Blooms
777 Lawrence Avenue East,
Toronto, Ontario M3C 1P2
Tel: 416-447-8655
Toll-free: 1-800-730-1020
Fax: 416-447-1567
E-Mail: info@canadablooms.com
Web: www.canadablooms.com

CANADA BLOOMS

March 15 – 24, 2013

Monday – Saturday 10 a.m. – 9 p.m.

Sunday, March 17 – 10 a.m. – 6 p.m.

Sunday March 24 – 10 a.m. – 5 p.m.

Direct Energy Centre

Exhibition Place, Toronto, Ontario

Tel: 416-447-855

Toll-free: 1-800-730-1020

Fax: 416-447-1567

Email: info@canadablooms.com

Web: www.canadablooms.com